



- Installation and wiring of luminaire must be in accordance with all applicable local codes.
- Installation, inspection, and maintenance of luminaires should be performed by a qualified electrician.
- DO NOT make or alter any open holes in the luminaire. Do not modify the luminaire.
- DO NOT install damaged product.
- Make sure electrical power is OFF before and during installation and maintenance.
- Make sure the equipment is properly grounded.
- Make sure the supply voltage is same as the rated fixture voltage.



| No. | Accessories | Picture | No. | Accessories | Picture |
|-----|------------------------|---------|-----|--------------|---------|
| 1 | Plastic expansion pipe | | 6 | Lock nut | |
| 2 | Screw | | 7 | Lock bolt | |
| 3 | Cylindrical bolt | | 8 | Metal buckle | |
| 4 | Cylindrical nut | | 9 | Connector 2 | |
| 5 | Seizing wire | | 10 | M6 Screw | |

The light source contained in this luminaire shall only be replaced by the manufacturer or his service agent or a similar qualified person

If the external flexible cable of this luminaire is damaged, it shall be exclusively replaced by the manufacturer or his service agent or a similar qualified person in order to avoid a hazard.

Terminal block not included. Installation may require advice from a qualified person.

Installation steps

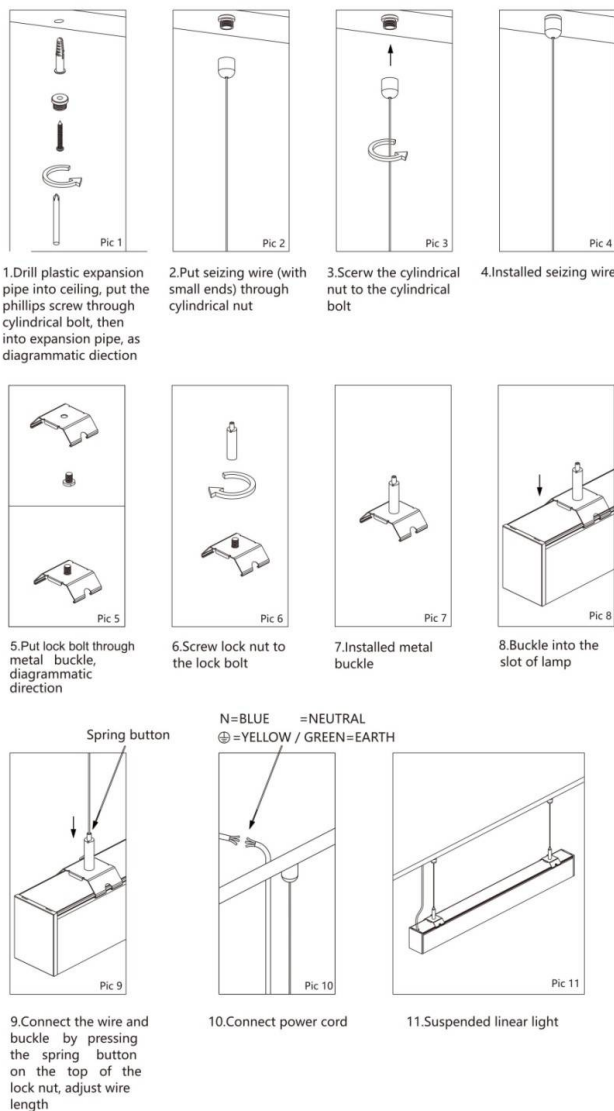

Connect steps

